



DIRECTIONAL CONTROL COMPACT VALVES 16 SERIES

PRODUCT CATALOG



Direct Solenoid Pilot Controlled Valves 16 Series

Product Overview

ROSS® direct acting solenoid pilot valves provide reliable pilot control for various pneumatically actuated devices. Main valve actuation requires maintained pilot signal.



Illustration example.

VALVE FEATURES

“PACER” Pilot Valve	Compact design, proven for great reliability
Quick Response	Short-stroke, lightweight valve elements
Mounting Options	Individual or manifold base mounting
High-shift Consistency	Designed for repeatability throughout the life of the valve

PRODUCT CREDENTIALS

CSA Certificate of Compliance 	Declaration of Conformity CE 	EAC 
--	--	---

STANDARD SPECIFICATIONS				
GENERAL	Function	3/2 Valve	Normally Closed	
			Normally Open	
		4/2 Valve		
	Construction Design	Poppet		
	Actuation	Electrical	Solenoid Pilot Controlled	
	Mounting	Inline		
		Manifold		
Connection	Threaded	NPT		
		G		
Manual Override	Flush-rubber; non-locking			
OPERATING CONDITIONS	Temperature	Ambient	40° to 120°F (4° to 50°C)	
		Media	40° to 175°F (4° to 80°C)	
	Flow Media	Filtered air		
	Operating Pressure	3/2 Valves	5 to 150 psig (0.3 to 10 bar)	
4/2 Valves		30 to 150 psig (2 to 10 bar)		
ELECTRICAL DATA FOR SOLENOID PILOT	Solenoids	Current Flow	Power Consumption	Operating Voltage (each solenoid)
		DC	24 volts	14 watts
		AC	110-120 volts, 50 Hz	87 VA inrush, 30 VA holding
		Rated for continuous duty		
CONSTRUCTION MATERIAL	Valve Body	Cast Aluminum		
	Poppet	Acetal		
	Seals	Buna-N		
IMPORTANT NOTE: Please read carefully and thoroughly all of the CAUTIONS, WARNINGS on the inside back cover.				

Ordering Information

3/2 Solenoid Pilot Controlled Valves

SOLENOID PILOT CONTROLLED VALVES

3-Way 2-Position Valves

Port Size		Valve Type	Valve Model Number *					
In-Out	Exhaust		NPT Thread			G Thread		
			24 V DC	110-120 V AC	230 V AC	24 V DC	110-120 V AC	230 V AC
1/8	1/2	Normally Closed	1613B1020W	1613B1020Z	1613B1020Y	D1613B1020W	D1613B1020Z	D1613B1020Y
		Normally Open	1614B1020W	1614B1020Z	1614B1020Y	D1614B1020W	D1614B1020Z	D1614B1020Y
1/4	1/2	Normally Closed	1613B2020W	1613B2020Z	1613B2020Y	D1613B2020W	D1613B2020Z	D1613B2020Y
		Normally Open	1614B2020W	1614B2020Z	1614B2020Y	D1614B2020W	D1614B2020Z	D1614B2020Y

* For other voltages, consult ROSS.

Size		Flow C_v (NI/min)		Average Response Constants #			Weight lb (kg)
Port 1, 2	Port 3	Normally Closed (NC)	Normally Open (NO)	M	F		
					NC	NO	
1/4	1/2	0.3 (30)	0.3 (30)	5	2.90	2.90	1.4 (0.6)
3/8	1/2	0.3 (30)	0.3 (30)	5	2.90	2.90	1.4 (0.6)

Valve Response Time – Response Time (msec) = $M + (F \cdot V)$. This is the average time required to fill a volume V (cubic inches) to 90% of supply pressure or to exhaust it to 10% of supply pressure. M and F values are shown above.

4/2 Solenoid Pilot Controlled Valves

SOLENOID PILOT CONTROLLED VALVES

4-Way 2-Position Valves

Port Size		Valve Model Number *					
In-Out	Exhaust	NPT Thread			G Thread		
		24 V DC	110-120 V AC	230 V AC	24 V DC	110-120 V AC	230 V AC
1/4	1/2	1616C2020W	1616C2020Z	1616C2020Y	D1616C2020W	D1616C2020Z	D1616C2020Y

* For other voltages, consult ROSS.

Size		Flow C_v (NI/min)		Average Response Constants #			Weight lb (kg)
Port 1, 2, 4	Port 3	1-2	2-4	M	F		
					NC	NO	
1/4	1/2	0.3 (30)	0.3 (30)	5	2.90	2.90	2.4 (1.1)

Valve Response Time – Response Time (msec) = $M + (F \cdot V)$. This is the average time required to fill a volume V (cubic inches) to 90% of supply pressure or to exhaust it to 10% of supply pressure. M and F values are shown above.

Valve Schematics

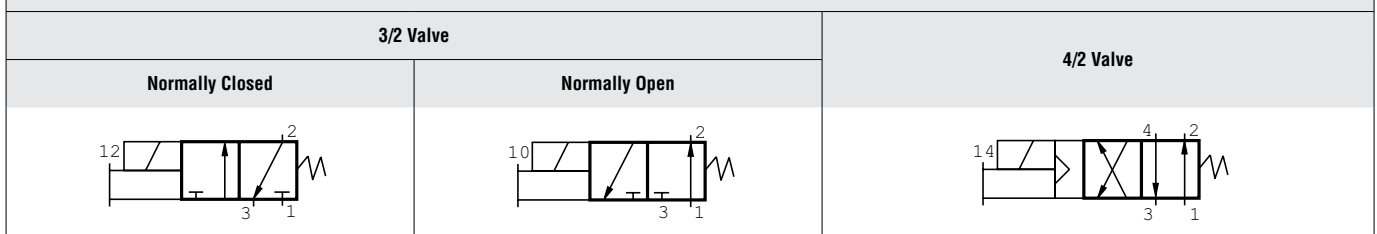

3/2 & 4/2 Solenoid Pilot Controlled Valves

DIMENSIONS

Inches (mm)

3/2 Valve

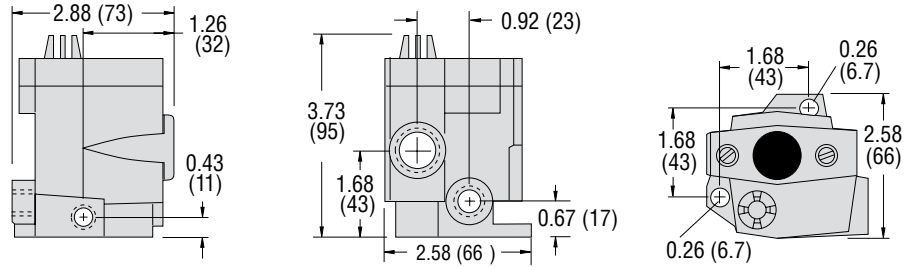

4/2 Valve

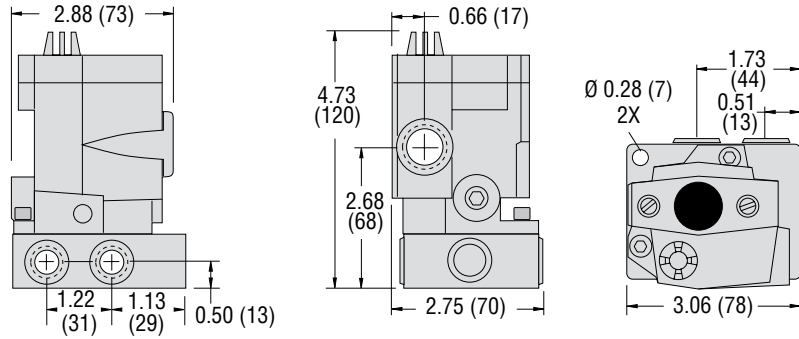

Downloadable CAD models available.

Port 2 (Outlet)

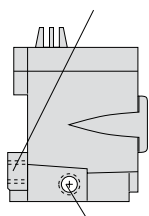

Y-3
1/8" Pilot Exhaust Port

1/2" Electrical Conduit Port

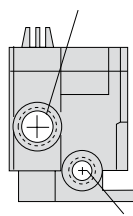

X-1
1/8" External Pilot Supply Port

Manual Override

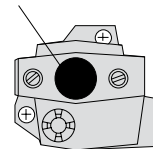

1/2" Electrical Conduit Port

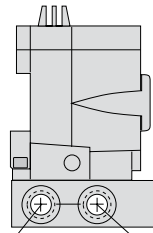

Port 4 (Outlet) Port 2 (Outlet)

Port 3 (Exhaust)

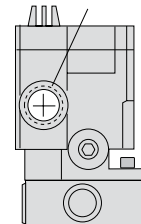

Manual Override

Port 1 (Inlet)

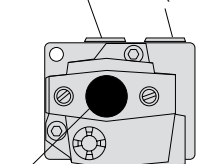

Ordering Information

3/2 Solenoid Pilot Controlled Valves & Manifolds

SOLENOID PILOT CONTROLLED VALVES

3-Way 2-Position Valves

Port Size		Valve Type	Valve Model Number*					
In-Out	Exhaust		NPT Thread			G Thread		
			24 V DC	110-120 V AC	230 V AC	24 V DC	110-120 V AC	230 V AC
1/4	1/2	Normally Closed	1613B2322W	1613B2322Z	1613B2322Y	D1613B2322W	D1613B2322Z	D1613B2322Y
		Normally Open	1614B2322W	1614B2322Z	1614B2322Y	D1614B2322W	D1614B2322Z	D1614B2322Y

For other voltages, consult ROSS.

* Manifold not included with the valve. Order Manifold Station model number 256B91.

Size		Flow C _v (NI/min)		Average Response Constants #			Weight lb (kg)
Port 1, 2	Port 3	Normally Closed (NC)	Normally Open (NO)	M	F		
					NC	NO	
1/4	1/2	0.3 (30)	0.3 (30)	5	2.90	2.90	2.4 (1.1)

Valve Response Time – Response Time (msec) = M + (F • V). This is the average time required to fill a volume V (cubic inches) to 90% of supply pressure or to exhaust it to 10% of supply pressure. M and F values are shown above.

4/2 Solenoid Pilot Controlled Valves & Manifolds

SOLENOID PILOT CONTROLLED VALVES

4-Way 2-Position Valves

Port Size		Valve Model Number*					
In-Out	Exhaust	NPT Thread			G Thread		
		24 V DC	110-120 V AC	230 V AC	24 V DC	110-120 V AC	230 V AC
1/4	1/2	1616C2320W	1616C2320Z	1616C2320Y	D1616C2320W	D1616C2320Z	D1616C2320Y

For other voltages, consult ROSS.

* Manifold not included with the valve. Order Manifold Station model number 257B91.

Size		Flow C _v (NI/min)		Average Response Constants #			Weight lb (kg)
Port 1, 2, 4	Port 3	Normally Closed (NC)	Normally Open (NO)	M	F		
					NC	NO	
1/4	1/2	0.3 (30)	0.3 (30)	5	2.90	2.90	2.4 (1.1)

Valve Response Time – Response Time (msec) = M + (F • V). This is the average time required to fill a volume V (cubic inches) to 90% of supply pressure or to exhaust it to 10% of supply pressure. M and F values are shown above.

Valve Schematics

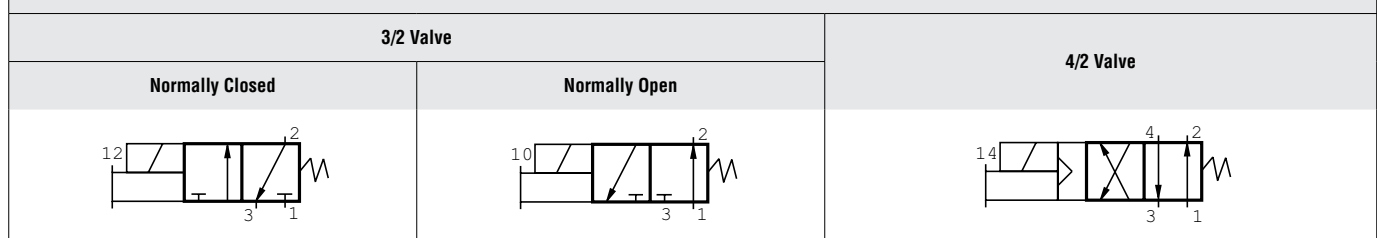

3/2 & 4/2 Solenoid Pilot Controlled Valves & Manifolds

DIMENSIONS

Inches (mm)

3/2 Valve & Manifold

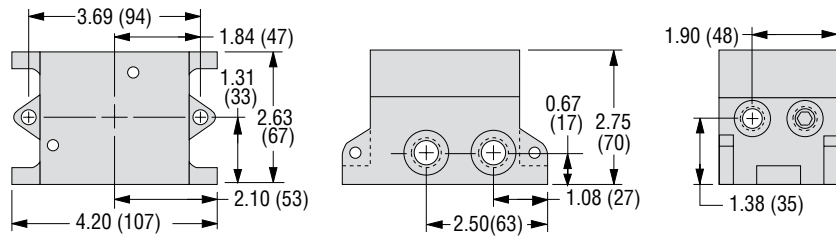
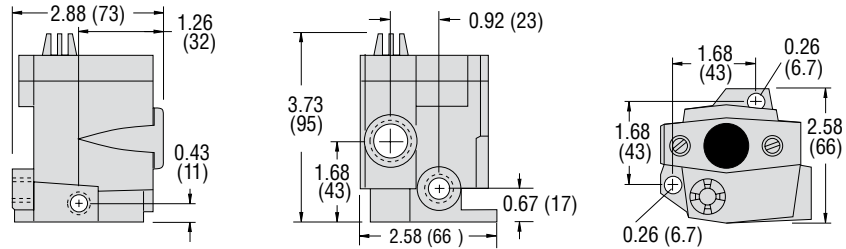

4/2 Valve & Manifold

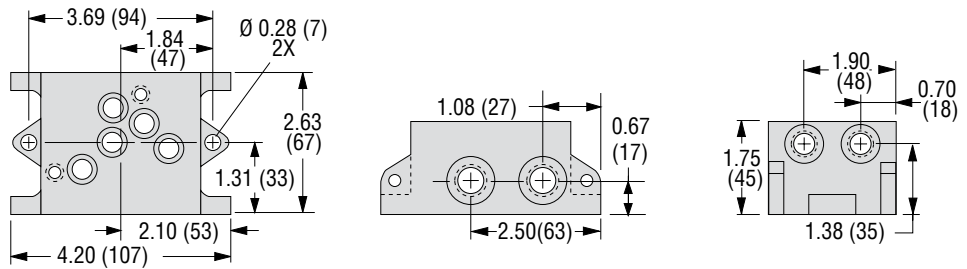
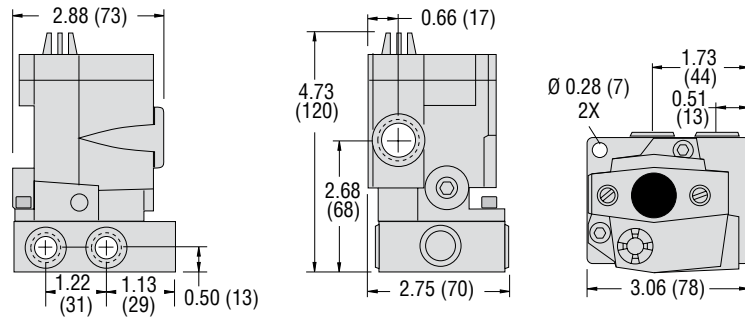

Downloadable CAD models available.

Port 3 (Exhaust) Port 1 (Inlet)

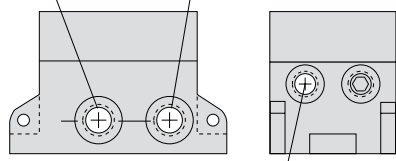

Port 2 (Outlet)

Port 3 (Exhaust) Port 1 (Inlet)

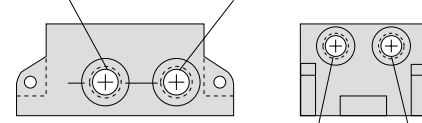

Port 2 (Outlet)

Port 4 (Outlet)

Accessories

EXHAUST SILENCERS

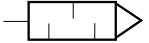

Illustration example.

Silencers	SPECIFICATIONS		Silencer Material		Pressure Range psig (bar)		Schematic	
			Aluminum		0-290 (0-20) maximum			
	Port Size	Thread Type	Flow C _v (NI/min)	Model Number		Dimensions inches (mm)		Weight lb (kg)
				NPT Thread	R/Rp Thread	Length	Hex Size (D)	
	1/8	Male	1.3 (1300)	5500A1003	D5500A1003	2.0 (5)	0.81 (21)	0.07 (0.03)
1/4	Male	2.3 (2300)	5500A2003	D5500A2003	2.2 (6)	0.81 (21)	0.07 (0.03)	

SOLENOID PILOT INDICATOR LIGHT KITS

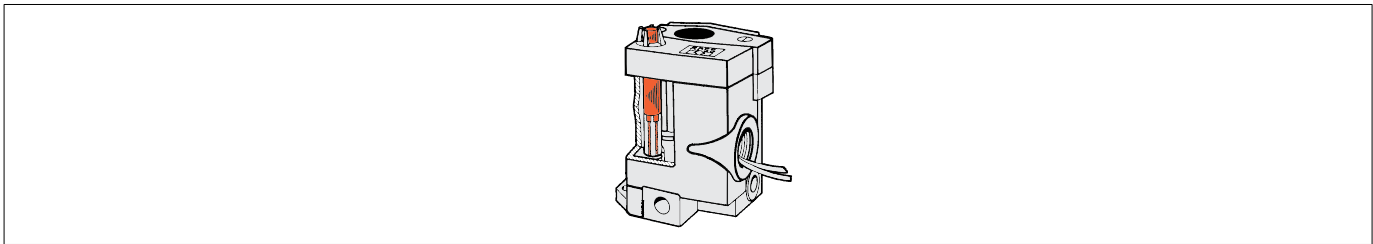

Illustration example.

Indicator Light Kits	Kit Number		
	24 V DC	110-120 V AC, 50-60 Hz	230 V AC, 50-60 Hz
	862K87-W	862K87-Z	862K87-Y

To visually verify valve operation, indicator light kits are available for single solenoid models. Indicator lights are standard on double solenoid valves. The indicator light is illuminated when the solenoid is energized.

SOLENOID PILOT MANUAL OVERRIDE KITS



Illustration examples.

Manual Override Kits	Manual Override Type	Kit Number	
		Locking Type	Non-Locking Type
	Flush Button	792K87	790K87
Extended Button	–	791K87	
Extended Button with Palm	–	984H87	

Flush rubber button, non-locking manual override is standard on solenoid models.
 Each of the buttons in the override kits is made of metal and is spring-returned. The locking type button, however, can be kept in the actuated position by turning the slot in the top of the button with a screwdriver.

CAUTIONS, WARNINGS And STANDARD WARRANTY



ROSS OPERATING VALVE, ROSS CONTROLS®, ROSS DECCO®, and AUTOMATIC VALVE INDUSTRIAL, collectively the “ROSS Group”.

PRE-INSTALLATION or SERVICE

1. Before servicing a valve or other pneumatic component, be sure all sources of energy are turned off, the entire pneumatic system is shut down and exhausted, and all power sources are locked out (ref: OSHA 1910.147, EN 1037).
2. All ROSS Group Products, including service kits and parts, should be installed and/or serviced only by persons having training and experience with pneumatic equipment. Because any product can be tampered with and/or need servicing after installation, persons responsible for the safety of others or the care of equipment must check ROSS Group Products on a regular basis and perform all necessary maintenance to ensure safe operating conditions.
3. All applicable instructions should be read and complied with before using any fluid power system to prevent harm to persons or equipment. In addition, overhauled or serviced valves must be functionally tested prior to installation and use. If you have any questions, call your nearest ROSS Group location.
4. Each ROSS Group Product should be used within its specification limits. In addition, use only ROSS Group components to repair ROSS Group Products.

WARNINGS:

Failure to follow these instructions can result in personal injury and/or property damage.

FILTRATION and LUBRICATION

1. Dirt, scale, moisture, etc., are present in virtually every air system. Although some valves are more tolerant of these contaminants than others, best performance will be realized if a filter is installed to clean the air supply, thus preventing contaminants from interfering with the proper performance of the equipment. The ROSS Group recommends a filter with a 5-micron rating for normal applications.
2. All standard ROSS Group filters and lubricators with polycarbonate plastic bowls are designed for compressed air applications only. Use the metal bowl guard, where provided, to minimize danger from high pressure fragmentation in the event of bowl failure. Do not expose these products to certain fluids, such as alcohol or liquefied petroleum gas, as they can cause bowls to rupture, creating a combustible condition and hazardous leakage. Immediately replace crazed, cracked, or deteriorated bowls.
3. Only use lubricants which are compatible with materials used in the valves and other components in the system. Normally, compatible lubricants are petroleum base oils with oxidation inhibitors, an aniline point between 180°F (82°C) and 220°F (104°C), and an ISO 32, or lighter, viscosity. Avoid oils with

phosphate type additives which can harm polyurethane components, potentially leading to valve failure which risks personal injury, and/or damage to property.

WARNINGS:

Failure to follow these instructions can result in personal injury and/or property damage.

AVOID INTAKE/EXHAUST RESTRICTION

1. Do not restrict air flow in the supply line. To do so could reduce the pressure of the supply air below minimum requirements for the valve and thereby causing erratic action.
2. Do not restrict a valve's exhaust port as this can adversely affect its operation. Exhaust silencers must be resistant to clogging and must have flow capacities at least as great as the exhaust capacities of the valves. Contamination of the silencer can result in reduced flow and increased back pressure.

WARNINGS: Failure to follow these instructions can result in personal injury and/or property damage.

SAFETY APPLICATIONS

1. Mechanical Power Presses and other potentially hazardous machinery using a pneumatically controlled clutch and brake mechanism must use a press control double valve with a monitoring device. A double valve without a self-contained monitoring device should be used only in conjunction with a control system which assures monitoring of the valve. All double valve installations involving hazardous applications should incorporate a monitoring system which inhibits further operation of the valve and machine in the event of a failure within the valve mechanism.
2. Safe Exhaust (dump) valves without a self-contained monitoring device should be used only in conjunction with a control system which assures monitoring of the valve. All Safe Exhaust valve installations should incorporate a monitoring system which inhibits further operation of the valve and machine in the event of a failure within the valve mechanism.
3. Per specifications and regulations, the ROSS L-O-X® and L-O-X® with EEZ-ON®, N06 and N16 Series operation products are defined as energy isolation devices, NOT AS EMERGENCY STOP DEVICES.

WARNINGS:

Failure to follow these instructions can result in personal injury and/or property damage.

STANDARD WARRANTY

All products sold by the ROSS Group are warranted for a one-year period [with the exception of Filters, Regulators and Lubricators (“FRLs”) which are warranted for a period of seven (7) years] from the date of purchase. All products are, during their respective warranty periods, warranted to be free of defects in material and workmanship. The ROSS Group's obligation under this warranty is limited to repair, replacement or refund of the purchase price paid for products which the ROSS Group has determined, in its sole discretion, are defective. All warranties become void if a product has been subject to misuse, misapplication, improper maintenance, modification or tampering. Products for which warranty protection is sought must be returned to the ROSS Group freight prepaid.

THE WARRANTY EXPRESSED ABOVE IS IN LIEU OF AND EXCLUSIVE OF ALL OTHER WARRANTIES AND THE ROSS GROUP EXPRESSLY DISCLAIMS ALL OTHER WARRANTIES EITHER EXPRESSED OR IMPLIED WITH RESPECT TO MERCHANTABILITY OR FITNESS FOR A PARTICULAR PURPOSE. THE ROSS GROUP MAKES NO WARRANTY WITH RESPECT TO ITS PRODUCTS MEETING THE PROVISIONS OF ANY GOVERNMENTAL OCCUPATIONAL SAFETY AND/OR HEALTH LAWS OR REGULATIONS. IN NO EVENT IS THE ROSS GROUP LIABLE TO PURCHASER, USER, THEIR EMPLOYEES OR OTHERS FOR INCIDENTAL OR CONSEQUENTIAL DAMAGES WHICH MAY RESULT FROM A BREACH OF THE WARRANTY DESCRIBED ABOVE OR THE USE OR MISUSE OF THE PRODUCTS. NO STATEMENT OF ANY REPRESENTATIVE OR EMPLOYEE OF THE ROSS GROUP MAY EXTEND THE LIABILITY OF THE ROSS GROUP AS SET FORTH HEREIN.



AMERICAS	ROSS CONTROLS	USA	Tel: +1-248-764-1800	www.rosscontrols.com
	ROSS CONTROLS CANADA Ltd.	Canada	Tel: +1-416-251-7677	www.rosscanada.com
	ROSS DO BRASIL LTDA	Brazil	Tel: +55-11-4335-2200	www.rosscontrols.com.br
EUROPE	ROSS EUROPA GmbH	Germany	Tel: +49 (0)6103-7597-100	www.rosseuropa.com
	ROSS FRANCE SAS	France	Tel: +33-(0)1-49-45-65-65	www.rossfrance.com
	ROSS PNEUMATROL Ltd.	United Kingdom	Tel: +44 (0)1254 872277	www.rossuk.co.uk
ASIA & PACIFIC	ROSS CONTROLS INDIA Pvt. Ltd.	India	Tel: +91-44-2624-9040	www.rosscontrolsindia.com
	ROSS CONTROLS (CHINA) Ltd.	China	Tel: +86-21-6915-7961	www.rosscontrolschina.com
	ROSS ASIA K.K.	Japan	Tel: +81-42-778-7251	www.rossasia.co.jp
	AUTOMATIC VALVE INDUSTRIAL LLC	USA	Tel: +1-248-474-6700	www.automaticvalve.com
	ROSS DECCO COMPANY	USA	Tel: +1-248-764-1800	www.rossdecco.com
	ROSS PNEUMATROL Ltd.	United Kingdom	Tel: +44 (0)1254 872277	www.pneumatrol.com
	manufactIS GmbH	Germany	Tel: +49 (0)2013-16843-0	www.manufactis.net

Full-Service Global Locations

There are ROSS Distributors Throughout the World

To meet your requirements across the globe, ROSS distributors are located throughout the world. Through ROSS or its distributors, guidance is available for the selection of ROSS products, both for those using fluid power components for the first time and those designing complex systems.

Other literature is available for engineering, maintenance, and service requirements.

If you need products or specifications not shown in this catalog, please visit ROSS' website, contact ROSS or your ROSS distributor. The ROSS Support Team will be happy to assist you in selecting the best product for your application.